



# CCTV LED 5

## POWERFUL CCTV LED LIGHT

The CCTV LED 5 is a robust radiation tolerant CCTV LED light unit with high power illumination. The unit is equipped with brand new LED technology giving 5 000 Lumens.

### APPLICATIONS

- For nuclear CCTV applications where high illumination is needed and/or the objects are far away from the camera

### BENEFITS

- High radiation tolerance
- Powerful illumination and intensity
- 50 000 hours lifetime
- Its cable is halogen free and flame retardant

### SPECIFICATIONS

Dimensions (L*W*H)	80x120x105 mm (3.1"x 4.7"x 4.1")
Weight	1.4 kg (3.1 lbs)
Housing material	Painted aluminum
Maximum temperature	60°C (142°F)
Protection class	IP65
Typical luminous flux	5 000 lumen
Power consumption	45 Watt
Life time	50 000 h
Radiation tolerance (total dose)	100 000 Gy (10 000 000 rad)

*We reserve the right to alter specifications without prior notice*

### CCTV LED 5 IMAGES

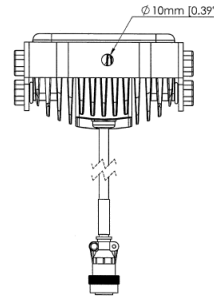
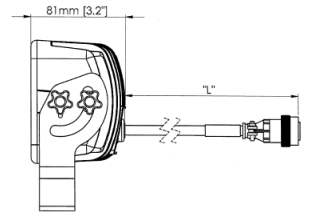
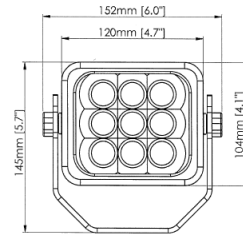

*We reserve the right to alter specifications without prior notice*